

LINN COUNTY DEPARTMENT OF HEALTH SERVICES BOARD OF HEALTH REPORT

ITEMS FOR BOARD OF HEALTH

AGENDA

March 19th, 2024

Reports for February 2024

I. Communicable Disease Report
A. February Report

II. Vital Statistic Reporting

A. Births 52

B. Deaths 110

1. Vital Statistics Summary

2. Vital Statistics Detail

LINN COUNTY DEPARTMENT OF HEALTH SERVICES COMMUNICABLE DISEASE REPORT

February 2024	*5 YR Avg February	Current Calendar Year to Date (YTD)	Previous Calendar YTD	Previous Calendar Year Total	**Avg YTD for Prior 5 Calendar Years
---------------	--------------------	-------------------------------------	-----------------------	------------------------------	--------------------------------------

Food and Waterborne/Ingestion Illness

Brucellosis	0	0	0	0	0	0
Botulism	0	0	0	0	0	0
Campylobacteriosis	5	2	8	4	35	31
Cryptosporidiosis	1	1	3	5	10	9
Giardiasis	0	0	0	2	15	7
Hepatitis A	0	0	0	0	0	0
Hepatitis E	0	0	0	0	0	0
HUS	0	0	0	0	0	0
Lead Poisoning	1	0	2	0	2	4
Listeriosis	0	0	0	0	1	1
Salmonellosis	2	0	10	0	10	8
Shiga-toxigenic E. coli	0	0	0	0	9	7
Shigellosis	0	0	0	0	2	2
Taeniasis/Cysticercosis	0	0	0	0	0	0
Trichinosis	0	0	0	0	0	0
Typhoid	0	0	0	0	0	0
Vibrio	0	0	0	0	1	0
Yersiniosis	1	0	1	0	2	1

Bloodborne/Sexually Transmitted Illness

AIDS/HIV	0	0	0	1	6	5
Chancroid	0	0	0	0	0	0
Chlamydia	24	33	46	55	315	356
Gonorrhea	6	11	14	11	74	109
Hepatitis B/Acute	0	0	0	0	0	0
Hepatitis B/Chronic	2	0	2	0	3	3
Hepatitis C/Acute	0	0	0	0	0	0
Hepatitis C/Chronic	5	14	13	23	115	139
Hepatitis D	0	0	0	0	0	0
Syphilis	2	3	4	3	39	31

Vector-borne/Zoonotic Illness

Animal Bites	36	23	80	55	352	330
Arthropod Vector-borne Disease	0	0	0	0	2	2
Dengue Fever	0	0	0	0	0	0
Hantavirus	0	0	0	0	0	0
Malaria	0	0	0	0	0	1
Q Fever	0	0	0	0	0	0
Tularemia	0	0	0	0	0	0

* "5 Yr Avg" does not include the current year.

** The "Avg YTD for Prior 5 Yrs" number is the average of the year to date number for the prior five years. It includes the previous year to date value. It does not include the current year.

*** Influenza laboratory confirmed death of a person <18 years of age.

LINN COUNTY DEPARTMENT OF HEALTH SERVICES COMMUNICABLE DISEASE REPORT

February 2024	*5 YR Avg February	Current Calendar Year to Date (YTD)	Previous Calendar YTD	Previous Calendar Year Total	**Avg YTD for Prior 5 Calendar Years
---------------	--------------------	-------------------------------------	-----------------------	------------------------------	--------------------------------------

Illness Acquired via Respiratory Exposure

A. Vaccine Preventable

Haemophilus Influenzae	1	0	1	0	3	2
Influenza***	0	0	0	0	0	0
Measles	0	0	0	0	0	0
Meningococcal Disease	0	0	0	0	0	0
Mumps	0	0	0	0	1	0
Pertussis	0	0	0	0	1	3
Rubella	0	0	0	0	0	0

B. Other

Coccidioidomycosis	0	0	1	0	1	0
Cryptococcosis	0	0	0	0	0	1
Legionellosis	0	0	0	0	0	1
Tuberculosis	0	0	0	0	1	1

Miscellaneous

Carbapenem Resistant Enterobacteriaceae	1	0	2	0	5	5
Nontuberculous Mycobacterial Infection	1	0	1	0	3	2
Candida Auris	0	N/A	0	0	1	N/A

* "5 Yr Avg" does not include the current year.

** The "Avg YTD for Prior 5 Yrs" number is the average of the year to date number for the prior five years. It includes the previous year to date value. It does not include the current year.

*** Influenza laboratory confirmed death of a person <18 years of age.

LINN COUNTY DEPARTMENT OF HEALTH SERVICES
LINN COUNTY BIRTHS

REPORTING MONTH:

February 2024

FEMALES	27
MALES	<u>25</u>
TOTAL	52

VITAL STATISTICS SUMMARY

Linn County Death Report 2/29/2024

Female: 65
 Male: 45
 Total: 110

	Primary Cause of Death
Age 30 - 39 yrs 1	1 Toxicology Pending
Age 40 - 49 yrs 1	1 Alcoholism
Age 50 - 59 yrs 2	1 GI Bleeding 1 Hernia
Age 60 - 69 yrs 13	1 Cancer: Adenocarcinoma 1 Cancer: Colon 1 Cancer: Hodgkin's Lymphoma 1 Cancer: Squamous Cell 1 Cerebrovascular Accident 1 Hypoglycemia 1 Liver Cirrhosis 2 Liver Failure 2 Toxicology Pending 1 Tumor 1 Undetermined Natural Causes
Age 70 - 79 yrs 38	1 Aspiration Pneumonia 1 Cancer: Adenocarcinoma 1 Cancer: Carcinoma 1 Cancer: Malignant Neoplasm 1 Cancer: Neuroendocrine 1 Cancer: Prostate 1 Cancer: Squamous Cell 1 Cardiac Arrest 1 Cardiopulmonary Arrest 1 Cerebrovascular Accident 1 Cirrhosis 2 Coronary Artery Disease 2 Dementia 1 Fracture 1 GI Bleeding 2 Heart Failure 1 Hemorrhage 1 Interstitial Lung Disease 1 Ischemic Colitis 1 Kidney Disease 1 Malnutrition 1 Pulmonary Fibrosis 4 Respiratory Failure

Primary Cause of Death

- 1 Sepsis
- 1 Septic Shock
- 1 Stroke
- 6 Undetermined Natural Causes

Age 80 - 89 yrs 39

- 1 Alzheimer's Disease
- 1 Aspiration Pneumonia
- 1 Cancer: Cholangiocarcinoma
- 1 Cancer: Malignant Neoplasm
- 1 Cancer: Squamous Cell
- 3 Cardiac Arrest
- 1 Cardiovascular Disease
- 1 Congestive Heart Failure
- 1 COPD Chronic Obstructive Pulmonary Disease
- 1 Coronary Artery Disease
- 1 Dementia
- 2 Failure to Thrive
- 1 Gunshot Wound to Head
- 1 Heart Disease
- 2 Heart Failure
- 2 Hemorrhage
- 1 Malnutrition
- 1 Parkinson's Disease
- 1 Respiratory Failure
- 1 Septic Shock
- 1 Thermal Injury
- 9 Undetermined Natural Causes
- 2 Unknown
- 2 Vascular Dementia

Age 90 - 99 yrs 13

- 1 Alzheimer's Disease
- 1 Cerebrovascular Accident
- 1 Cholecystitis
- 1 Failure to Thrive
- 1 Fracture
- 1 Heart Disease
- 1 Kidney Disease
- 1 Respiratory Failure
- 1 Sepsis
- 2 Undetermined Natural Causes
- 2 Vascular Dementia

Age 100 - 109 yrs 3

- 1 Aortic Stenosis
- 1 Gastrointestinal Bleed
- 1 Heart Disease

Primary Cause of Death

Total All Ages: 110

Tobacco Related:	26	23.64%
Alcohol Related:	5	4.55%
Diabetes Related:	23	20.91%
Drug Related:	0	0.00%

VITAL STATISTICS DETAIL

Linn County Death Report

2/29/2024

Female: 65
Male: 45
Total: 110

Ages Age 30 - 39 yrs

Primary COD	Contributing Causes	Death Date	Gender	Age	Manner of Death	Tobacco	Alcohol	Diabetes	Drug
Toxicology Pending		2/6/2024	M	34	Pending	<input type="checkbox"/>	<input type="checkbox"/>	<input type="checkbox"/>	<input type="checkbox"/>

Summary of Deaths by Decade: 1

Ages Age 40 - 49 yrs

Primary COD	Contributing Causes	Death Date	Gender	Age	Manner of Death	Tobacco	Alcohol	Diabetes	Drug
Alcoholism, Chronic		2/5/2024	M	47		<input checked="" type="checkbox"/>	<input checked="" type="checkbox"/>	<input type="checkbox"/>	<input type="checkbox"/>

Summary of Deaths by Decade: 1

Ages Age 50 - 59 yrs

Primary COD	Contributing Causes	Death Date	Gender	Age	Manner of Death	Tobacco	Alcohol	Diabetes	Drug
GI Bleeding	Esophagitis, Alcohol Use Disorder; Diabetes Type 2, HTN, Hypertlipidemia, Coronary Artery Disease	1/29/2024	M	54		<input type="checkbox"/>	<input checked="" type="checkbox"/>	<input checked="" type="checkbox"/>	<input type="checkbox"/>
Hernia, Cerebral Herniation	Ischemic Stroke, Bilateral ICA Occlusion	1/30/2024	F	57		<input type="checkbox"/>	<input type="checkbox"/>	<input type="checkbox"/>	<input type="checkbox"/>

Summary of Deaths by Decade: 2

Ages Age 60 - 69 yrs

Primary COD	Contributing Causes	Death Date	Gender	Age	Manner of Death	Tobacco	Alcohol	Diabetes	Drug
Cancer: Adenocarcinoma, Metastatic Left Lung to Bone	Non-Alcoholic Fatty Liver	2/21/2024	F	69		<input type="checkbox"/>	<input type="checkbox"/>	<input type="checkbox"/>	<input type="checkbox"/>
Cancer: Colon	Metastatic to Liver, Lung, Malignant Ascites	2/4/2024	F	63		<input type="checkbox"/>	<input type="checkbox"/>	<input type="checkbox"/>	<input type="checkbox"/>
Cancer: Hodgkin's Lymphoma, Stage 4 w/Metastasis to Bone Marrow	HTN, Essential	2/22/2024	F	69		<input type="checkbox"/>	<input type="checkbox"/>	<input type="checkbox"/>	<input type="checkbox"/>
Cancer: Squamous Cell, Hypopharynx	Hx of Squamous cell Carcinoma of Lung, Tobacco Smoker	2/2/2024	M	67		<input checked="" type="checkbox"/>	<input type="checkbox"/>	<input type="checkbox"/>	<input type="checkbox"/>
Cerebrovascular Accident, Left Pontine	Non ST-Elevated Myocardial Infarction, Chronic Heart Failure w/Reduced Ejection Fraction, Carotid Artery Stenosis, COPD	2/21/2024	F	60		<input checked="" type="checkbox"/>	<input type="checkbox"/>	<input type="checkbox"/>	<input type="checkbox"/>

Primary COD	Death Date	Gender	Age	Manner of Death	Tobacco	Alcohol	Diabetes	Drug
Hypoglycemia	2/8/2024	F	62	Insulin Dependent Type 2 Diabetes, Elevated BMI, Fatigue, Weakness, Meningioma, Spinal Stenosis, Chronic Pain w/Narcotic Use, Leg Ulcers from Edema, Long Term Anticoagulation; Bipolar Disorder Non Compliance d/t Financial Concerns, Deconditioning Berevement d/t Father's Passing, Hx of Falls, Leg Weakness	<input checked="" type="checkbox"/>	<input type="checkbox"/>	<input checked="" type="checkbox"/>	<input type="checkbox"/>
Liver Cirrhosis, Alcoholic, w/Ascites	2/29/2024	M	65	Hepatic Encephalopathy, Recent Ground Level Fall w/Closed Fracture of One Rib & Nasal Bone, Peripheral Vascular Disease, Esophageal Varices	<input type="checkbox"/>	<input checked="" type="checkbox"/>	<input type="checkbox"/>	<input type="checkbox"/>
Liver Failure	2/10/2024	F	64	Cirrhosis, Alcohol Use Disorder; CKD	<input type="checkbox"/>	<input checked="" type="checkbox"/>	<input type="checkbox"/>	<input type="checkbox"/>
Liver Failure	2/13/2024	F	66	Metastatic Breast Cancer; Primary Biliary Cirrhosis	<input type="checkbox"/>	<input type="checkbox"/>	<input type="checkbox"/>	<input type="checkbox"/>
Toxicology Pending	2/20/2024	M	65	Pending	<input type="checkbox"/>	<input type="checkbox"/>	<input type="checkbox"/>	<input type="checkbox"/>
Toxicology Pending	2/5/2024	M	66		<input type="checkbox"/>	<input type="checkbox"/>	<input type="checkbox"/>	<input type="checkbox"/>
Tumor, Stage 4 Solitary Fibrosis, of the Abdomen w/ Abdominal Carcinomatosis, Malignant Ascites, Metastasis in Abdomen	2/20/2024	M	66		<input type="checkbox"/>	<input type="checkbox"/>	<input type="checkbox"/>	<input type="checkbox"/>
Undetermined Natural Causes	2/22/2024	M	68	HTN	<input type="checkbox"/>	<input type="checkbox"/>	<input type="checkbox"/>	<input type="checkbox"/>

Summary of Deaths by Decade: 13

Agnes Age 70 - 79 yrs

Primary COD	Death Date	Gender	Age	Manner of Death	Tobacco	Alcohol	Diabetes	Drug
Aspiration Pneumonia	2/1/2024	F	71	COPD; Severe Dementia, DM2, Hypoxia	<input checked="" type="checkbox"/>	<input type="checkbox"/>	<input checked="" type="checkbox"/>	<input type="checkbox"/>
Cancer: Adenocarcinoma, Pancreatic, Head of Pancreas, Metastases to Liver & Peritoneal Nodule in Left Lower Quadrant	2/7/2024	F	79	Cecal Volvulus	<input type="checkbox"/>	<input type="checkbox"/>	<input type="checkbox"/>	<input type="checkbox"/>
Cancer: Carcinoma, Fallopian Tube High Grade Serous, Unspecified Laterality, Metastatic for Ovary, Carcinomatosis	2/18/2024	F	74	Malignant Ascites, Hx of Infiltrating Ductal Carcinoma of Central Portion of Right Breast, Hx of Malignant Neoplasm of Tongue	<input type="checkbox"/>	<input type="checkbox"/>	<input type="checkbox"/>	<input type="checkbox"/>
Cancer: Malignant Neoplasm, Recurrent, Left Breast	1/31/2024	F	79	Carcinoma of Breast Metastatic to Skin, Right, Secondary & Unspecified Malignant Neoplasm of Lymph Nodes of Head, Face & Neck; Lymphedema of Left Upper Extremity, Essential HTN, Seizure Disorder	<input type="checkbox"/>	<input type="checkbox"/>	<input type="checkbox"/>	<input type="checkbox"/>
Cancer: Neuroendocrine, Small Bowel, Metastasis Mesenteric Lymph Nodes & Liver	2/14/2024	M	79	Heart Mass, COPD	<input type="checkbox"/>	<input type="checkbox"/>	<input type="checkbox"/>	<input type="checkbox"/>
Cancer: Prostate	2/18/2024	M	77		<input type="checkbox"/>	<input type="checkbox"/>	<input type="checkbox"/>	<input type="checkbox"/>

Cancer: Squamous Cell, Right Mandible	2/6/2024	M	72	<input type="checkbox"/>	<input type="checkbox"/>	<input type="checkbox"/>	<input type="checkbox"/>	<input type="checkbox"/>	<input type="checkbox"/>
Cardiac Arrest	2/22/2024	M	70	<input checked="" type="checkbox"/>	<input type="checkbox"/>	<input type="checkbox"/>	<input type="checkbox"/>	<input type="checkbox"/>	<input type="checkbox"/>
Cardiopulmonary Arrest	2/15/2024	M	75	<input checked="" type="checkbox"/>	<input type="checkbox"/>	<input type="checkbox"/>	<input type="checkbox"/>	<input type="checkbox"/>	<input type="checkbox"/>
Cerebrovascular Accident, Acute	2/11/2024	F	72	<input type="checkbox"/>	<input type="checkbox"/>	<input type="checkbox"/>	<input type="checkbox"/>	<input type="checkbox"/>	<input type="checkbox"/>
Cirrhosis, Hepatic, d/t Primary Biliary Cholangitis	2/29/2024	F	74	<input type="checkbox"/>	<input type="checkbox"/>	<input type="checkbox"/>	<input type="checkbox"/>	<input type="checkbox"/>	<input type="checkbox"/>
Coronary Artery Disease	2/24/2024	F	79	<input type="checkbox"/>	<input type="checkbox"/>	<input type="checkbox"/>	<input checked="" type="checkbox"/>	<input type="checkbox"/>	<input type="checkbox"/>
Coronary Artery Disease	2/7/2024	M	74	<input checked="" type="checkbox"/>	<input type="checkbox"/>	<input type="checkbox"/>	<input type="checkbox"/>	<input type="checkbox"/>	<input type="checkbox"/>
Dementia	2/27/2024	F	78	<input type="checkbox"/>	<input type="checkbox"/>	<input type="checkbox"/>	<input type="checkbox"/>	<input type="checkbox"/>	<input type="checkbox"/>
Dementia, Lewy Body	2/2/2024	M	79	<input type="checkbox"/>	<input type="checkbox"/>	<input type="checkbox"/>	<input checked="" type="checkbox"/>	<input type="checkbox"/>	<input type="checkbox"/>
Fracture, Right Humerus, Complications	2/22/2024	F	78	<input type="checkbox"/>	<input type="checkbox"/>	<input type="checkbox"/>	<input type="checkbox"/>	<input type="checkbox"/>	<input type="checkbox"/>
GI Bleeding, Acute	2/27/2024	M	74	<input checked="" type="checkbox"/>	<input checked="" type="checkbox"/>	<input type="checkbox"/>	<input type="checkbox"/>	<input type="checkbox"/>	<input type="checkbox"/>
Heart Failure, Chronic, w/Preserved Ejection Fraction	2/20/2024	F	76	<input type="checkbox"/>	<input type="checkbox"/>	<input type="checkbox"/>	<input checked="" type="checkbox"/>	<input type="checkbox"/>	<input type="checkbox"/>
Heart Failure, Chronic, Systolic	2/6/2024	M	77	<input type="checkbox"/>	<input type="checkbox"/>	<input type="checkbox"/>	<input type="checkbox"/>	<input type="checkbox"/>	<input type="checkbox"/>
Hemorrhage, Gastrointestinal, Unspecified	2/25/2024	F	78	<input type="checkbox"/>	<input type="checkbox"/>	<input type="checkbox"/>	<input checked="" type="checkbox"/>	<input type="checkbox"/>	<input type="checkbox"/>
Interstitial Lung Disease	2/22/2024	M	72	<input checked="" type="checkbox"/>	<input type="checkbox"/>	<input type="checkbox"/>	<input checked="" type="checkbox"/>	<input type="checkbox"/>	<input type="checkbox"/>
Ischemic Colitis	2/9/2024	M	74	<input checked="" type="checkbox"/>	<input type="checkbox"/>	<input type="checkbox"/>	<input type="checkbox"/>	<input type="checkbox"/>	<input type="checkbox"/>

Kidney Disease, Chronic, Stage 4	2/16/2024	F	75	HTN, Necrotizing Fasciitis Status Post Below Knee Amputation of Left Leg	<input type="checkbox"/>	<input type="checkbox"/>	<input type="checkbox"/>	<input type="checkbox"/>
Malnutrition, Unspecified Severe Protein-Calorie	2/21/2024	F	77	Alzheimer's Disease, Unspecified	<input type="checkbox"/>	<input type="checkbox"/>	<input type="checkbox"/>	<input type="checkbox"/>
Pulmonary Fibrosis, Idiopathic	2/28/2024	M	79	Aortic Valve Stenosis, Diabetes Type 2, HTN, Coronary Atherosclerosis	<input type="checkbox"/>	<input type="checkbox"/>	<input checked="" type="checkbox"/>	<input type="checkbox"/>
Respiratory Failure, Hypoxic	2/16/2024	M	74	COPD Exacerbation	<input checked="" type="checkbox"/>	<input type="checkbox"/>	<input type="checkbox"/>	<input type="checkbox"/>
Respiratory Failure, Acute, w/Hypoxia	1/24/2024	M	75	Septic Shock	<input type="checkbox"/>	<input type="checkbox"/>	<input type="checkbox"/>	<input type="checkbox"/>
Respiratory Failure, Chronic w/Hypoxia & Hypercapnia	2/20/2024	F	74	Panlobular Emphysema; Pulmonary HTN, Chronic Heart Failure w/Preserved Ejection Fraction, DM2 w/o Complication	<input checked="" type="checkbox"/>	<input type="checkbox"/>	<input type="checkbox"/>	<input checked="" type="checkbox"/>
Respiratory Failure, Chronic Hypoxic Sepsis, d/t Unspecified Organism	2/23/2024	F	78	COPD; Acute Pulmonary Edema, HTN	<input checked="" type="checkbox"/>	<input type="checkbox"/>	<input type="checkbox"/>	<input type="checkbox"/>
Septic Shock, Secondary to Left Lower Extremity Cellulitis	2/9/2024	M	73	Protein Calorie Malnutrition, Panlobular Emphysema, Peripheral Vascular Disease	<input checked="" type="checkbox"/>	<input type="checkbox"/>	<input type="checkbox"/>	<input type="checkbox"/>
Stroke, Left Middle Cerebral Artery, Acute Ischemic	2/17/2024	F	71	Peripheral Vascular Disease; Atrial Fibrillation, CHF, HTN	<input type="checkbox"/>	<input type="checkbox"/>	<input type="checkbox"/>	<input type="checkbox"/>
Undetermined Natural Causes	2/26/2024	F	78	Heart Failure w/Reduced Ejection Fraction, Paroxymal Atrial Fibrillation w/Rapid Ventricular Response	<input type="checkbox"/>	<input type="checkbox"/>	<input type="checkbox"/>	<input type="checkbox"/>
Undetermined Natural Causes	2/24/2024	F	70	Chronic Cerebral Ischemia, Poorly Controlled DM2	<input type="checkbox"/>	<input type="checkbox"/>	<input checked="" type="checkbox"/>	<input type="checkbox"/>
Undetermined Natural Causes	2/12/2024	M	72	Osteoarthritis of Multiple Joints, Family Hx of Heart Disease	<input type="checkbox"/>	<input type="checkbox"/>	<input type="checkbox"/>	<input type="checkbox"/>
Undetermined Natural Causes	2/25/2024	F	77	Chronic Cerebral Ischemia, DM2 w/o Complication, w/o Long-Term Current Use of Insulin, Peripheral Vascular Disease	<input type="checkbox"/>	<input type="checkbox"/>	<input type="checkbox"/>	<input checked="" type="checkbox"/>
Undetermined Natural Causes	2/18/2024	F	77	Late Cortical Cerebellar Atrophy, Dementia w/Visual Impairment due to Posterior Cerebral Cortical Atrophy	<input type="checkbox"/>	<input type="checkbox"/>	<input type="checkbox"/>	<input type="checkbox"/>
Undetermined Natural Causes	2/18/2024	F	78	COPD, Smoking	<input checked="" type="checkbox"/>	<input type="checkbox"/>	<input type="checkbox"/>	<input type="checkbox"/>
Undetermined Natural Causes	2/20/2024	F	79	Alzheimer's Disease	<input type="checkbox"/>	<input type="checkbox"/>	<input type="checkbox"/>	<input type="checkbox"/>

Summary of Deaths by Decade: 38

Ages Age 80 - 89 yrs

Primary COD	Contributing Causes	Death Date	Gender	Age	Manner of Death	Tobacco	Alcohol	Diabetes	Drug
Alzheimer's Disease	Atrial Fibrillation, HTN, Thrombocytopenia	2/20/2024	F	86		<input type="checkbox"/>	<input type="checkbox"/>	<input type="checkbox"/>	<input type="checkbox"/>

Aspiration Pneumonia	2/8/2024	M	88	Esophageal Dysphagia, Chronic Hypoxic Respiratory Failure, Pulmonary Emphysema; Heart Failure w/Reduced Ejection Fraction	<input checked="" type="checkbox"/>	<input type="checkbox"/>	<input type="checkbox"/>	<input type="checkbox"/>
Cancer: Cholangiocarcinoma	3/3/2024	F	83	Hepatocellular Carcinoma	<input type="checkbox"/>	<input type="checkbox"/>	<input type="checkbox"/>	<input type="checkbox"/>
Cancer: Malignant Neoplasm, Primary, of Breast w/Metastasis to Bone	2/22/2024	F	82	Cancer w/Leptoeningeal Spread, Benign Essential HTN, Severe Protein-Calorie Malnutrition	<input type="checkbox"/>	<input type="checkbox"/>	<input type="checkbox"/>	<input type="checkbox"/>
Cancer: Squamous Cell, Right Lung	2/29/2024	F	85	COPD, Former Tobacco Smoker	<input checked="" type="checkbox"/>	<input type="checkbox"/>	<input type="checkbox"/>	<input type="checkbox"/>
Cardiac Arrest	2/13/2024	F	80	Probable Myocardial Infarction, CAD, DM2; Obesity & Hyperlipidemia	<input type="checkbox"/>	<input type="checkbox"/>	<input checked="" type="checkbox"/>	<input type="checkbox"/>
Cardiac Arrest, Acute	2/14/2024	M	87	Chronic Combined Systolic Diastolic Heart Failure, Severe Aortic Stenosis; Hyperlipidemia, Previous CVA, Cognitive Impairment	<input type="checkbox"/>	<input type="checkbox"/>	<input type="checkbox"/>	<input type="checkbox"/>
Cardiac Arrest, Secondary to Hypoxic Respiratory Failure	2/22/2024	M	82	Pneumonia d/t Inhalation of Gastric Contents, Sequelae of Cerebral Infarction w/Dysphagia, Cerebrovascular Disease; Vascular Dementia, Heart Failure, HTN, Non-Rheumatic Mitral Valve Stenosis w/Insufficiency, Atrial Fibrillation	<input type="checkbox"/>	<input type="checkbox"/>	<input type="checkbox"/>	<input type="checkbox"/>
Cardiovascular Disease, Atherosclerotic	2/13/2024	F	81	Atrial Fibrillation w/Rapid Ventricular Response; Sick Sinus Syndrome, Severe Protein-Calorie Malnutrition	<input type="checkbox"/>	<input type="checkbox"/>	<input type="checkbox"/>	<input type="checkbox"/>
Congestive Heart Failure, Chronic Systolic	2/1/2024	F	88	HTN, Benign	<input type="checkbox"/>	<input type="checkbox"/>	<input type="checkbox"/>	<input type="checkbox"/>
COPD Chronic Obstructive Pulmonary Disease	2/23/2024	F	82	DM, Rectal Cancer	<input checked="" type="checkbox"/>	<input type="checkbox"/>	<input type="checkbox"/>	<input type="checkbox"/>
Coronary Artery Disease, Atherosclerotic, Probable Acute Complications	2/15/2024	F	82	Ischemic Left MCA Stroke, HTN; Diabetes Type 2, Chronic Combined Systolic & Diastolic Heart Failure	<input type="checkbox"/>	<input type="checkbox"/>	<input checked="" type="checkbox"/>	<input type="checkbox"/>
Dementia, w/Lewy Bodies	2/3/2024	M	82	Ischemic Left MCA Stroke, HTN; Diabetes Type 2, Chonic Combined Systolic & Diastolic Heart Failure	<input type="checkbox"/>	<input type="checkbox"/>	<input type="checkbox"/>	<input type="checkbox"/>
Failure to Thrive, Adult	2/26/2024	F	86	CHF, CAD	<input type="checkbox"/>	<input type="checkbox"/>	<input checked="" type="checkbox"/>	<input type="checkbox"/>
Failure to Thrive, Adult	2/26/2024	F	86	Atrial Fibrillation, Severe Pulmonary HTN, COPD, Hx of Tobacco Use	<input type="checkbox"/>	<input type="checkbox"/>	<input checked="" type="checkbox"/>	<input type="checkbox"/>
Gunshot Wound to Head	2/24/2024	M	83	Suicide	<input checked="" type="checkbox"/>	<input type="checkbox"/>	<input type="checkbox"/>	<input type="checkbox"/>
Heart Disease, Hypertensive, and Kidney Disease w/ Heart & Renal Failure	2/11/2024	M	83		<input checked="" type="checkbox"/>	<input type="checkbox"/>	<input type="checkbox"/>	<input type="checkbox"/>
Heart Failure, w/ Hypertensive Heart, and CKD3B	2/16/2024	F	89		<input type="checkbox"/>	<input type="checkbox"/>	<input type="checkbox"/>	<input type="checkbox"/>
Heart Failure	2/27/2024	M	84		<input checked="" type="checkbox"/>	<input type="checkbox"/>	<input type="checkbox"/>	<input type="checkbox"/>

Hemorrhage, Intracranial, Traumatic	Fall from Standing Height	2/21/2024	M	82	Accident	<input type="checkbox"/>	<input type="checkbox"/>	<input type="checkbox"/>	<input type="checkbox"/>	<input type="checkbox"/>	<input type="checkbox"/>	<input type="checkbox"/>
Hemorrhage, Probable Traumatic Intracranial	Atrial Fibrillation on Apixaban, Prostate Cancer	2/15/2024	M	88	Accident	<input type="checkbox"/>	<input type="checkbox"/>	<input type="checkbox"/>	<input type="checkbox"/>	<input type="checkbox"/>	<input type="checkbox"/>	<input type="checkbox"/>
Malnutrition, Severe	Recurrent Intestinal Obstruction; Atrial Fibrillation w/Rapid Ventricular Response, Abdominal Aortic Aneurysm w/o Rupture	2/23/2024	M	86		<input type="checkbox"/>	<input type="checkbox"/>	<input type="checkbox"/>	<input type="checkbox"/>	<input type="checkbox"/>	<input type="checkbox"/>	<input type="checkbox"/>
Parkinson's Disease	Metabolic Acidosis, Acute	10/18/2023	F	82		<input type="checkbox"/>	<input type="checkbox"/>	<input type="checkbox"/>	<input type="checkbox"/>	<input type="checkbox"/>	<input type="checkbox"/>	<input type="checkbox"/>
Respiratory Failure, Acute	Cholecystitis; Vascular Dementia, CKD, HTN	2/1/2024	F	85		<input type="checkbox"/>	<input type="checkbox"/>	<input type="checkbox"/>	<input type="checkbox"/>	<input type="checkbox"/>	<input type="checkbox"/>	<input type="checkbox"/>
Septic Shock	Urinary Tract Infection, Colovesical Fistula, Cervical & Endometrial Cancer w/Hysterectomy & Radiation Therapy; Cirrhosis w/Ascites, Obesity, Diabetes Type 2	2/9/2024	F	81		<input type="checkbox"/>	<input type="checkbox"/>	<input type="checkbox"/>	<input checked="" type="checkbox"/>	<input type="checkbox"/>	<input type="checkbox"/>	<input type="checkbox"/>
Thermal Injury, Complications	Urinary Tract Infection, Healthcare Associated Pneumonia, HTN, Transient Ischemic Attack	2/19/2024	F	80	Accident	<input type="checkbox"/>	<input type="checkbox"/>	<input type="checkbox"/>	<input type="checkbox"/>	<input type="checkbox"/>	<input type="checkbox"/>	<input type="checkbox"/>
Undetermined Natural Causes	Alzheimer's Disease; HTN	2/1/2024	F	83		<input type="checkbox"/>	<input type="checkbox"/>	<input type="checkbox"/>	<input type="checkbox"/>	<input type="checkbox"/>	<input type="checkbox"/>	<input type="checkbox"/>
Undetermined Natural Causes	Alzheimer's Disease w/Early Onset	2/7/2024	F	83		<input type="checkbox"/>	<input type="checkbox"/>	<input type="checkbox"/>	<input type="checkbox"/>	<input type="checkbox"/>	<input type="checkbox"/>	<input type="checkbox"/>
Undetermined Natural Causes	Late Effect of CVA; Systemic Lupus Erythematosus, Diastolic Heart Failure	2/20/2024	F	86		<input type="checkbox"/>	<input type="checkbox"/>	<input type="checkbox"/>	<input type="checkbox"/>	<input type="checkbox"/>	<input type="checkbox"/>	<input type="checkbox"/>
Undetermined Natural Causes	Cerebrovascular Accident, Crohn's Disease, Protein Calorie Malnutrition	2/23/2024	F	81		<input checked="" type="checkbox"/>	<input type="checkbox"/>	<input type="checkbox"/>	<input type="checkbox"/>	<input type="checkbox"/>	<input type="checkbox"/>	<input type="checkbox"/>
Undetermined Natural Causes	Chronic Cerebral Ischemia; CAD, Essential HTN, Peripheral Vascular Disease	2/23/2024	M	82		<input type="checkbox"/>	<input type="checkbox"/>	<input type="checkbox"/>	<input type="checkbox"/>	<input type="checkbox"/>	<input type="checkbox"/>	<input type="checkbox"/>
Undetermined Natural Causes	Compression Fracture of T5 Vertebrae, Fall at Home, Dementia; Pressure Ulcer of Back & Buttocks, Stage 2, Cirrhosis, COPD Diabetes Type 2, CAD, CHF, Atrial Fibrillation	2/17/2024	M	87		<input type="checkbox"/>	<input type="checkbox"/>	<input type="checkbox"/>	<input checked="" type="checkbox"/>	<input type="checkbox"/>	<input type="checkbox"/>	<input type="checkbox"/>
Undetermined Natural Causes	Age Related Cognitive Decline; CAD	2/18/2024	F	85		<input type="checkbox"/>	<input type="checkbox"/>	<input type="checkbox"/>	<input type="checkbox"/>	<input type="checkbox"/>	<input type="checkbox"/>	<input type="checkbox"/>
Undetermined Natural Causes	Alzheimer's Disease; Pulmonary HTN, Aortic Valve Stenosis, Permanent Atrial Fibrillation, DM2	2/22/2024	M	88		<input type="checkbox"/>	<input type="checkbox"/>	<input type="checkbox"/>	<input checked="" type="checkbox"/>	<input type="checkbox"/>	<input type="checkbox"/>	<input type="checkbox"/>
Undetermined Natural Causes	Coronary Artery Disease, Atrial Fibrillation, Hx of CVA, Carotid Artery Stenosis, CHF Reduced Ejection Fraction, Vascular Dementia	2/15/2024	F	80		<input type="checkbox"/>	<input type="checkbox"/>	<input type="checkbox"/>	<input type="checkbox"/>	<input type="checkbox"/>	<input type="checkbox"/>	<input type="checkbox"/>
Unknown, Age Related Cause	Interstitial Lung Disease	1/30/2024	F	84		<input type="checkbox"/>	<input type="checkbox"/>	<input type="checkbox"/>	<input type="checkbox"/>	<input type="checkbox"/>	<input type="checkbox"/>	<input type="checkbox"/>
Unknown		2/10/2024	M	80		<input type="checkbox"/>	<input type="checkbox"/>	<input type="checkbox"/>	<input type="checkbox"/>	<input type="checkbox"/>	<input type="checkbox"/>	<input type="checkbox"/>

Vascular Dementia	HTN; CAD, CHF	2/16/2024	F	84	<input type="checkbox"/>	<input type="checkbox"/>	<input type="checkbox"/>	<input type="checkbox"/>	<input type="checkbox"/>	<input type="checkbox"/>
Vascular Dementia	Cerebral Ischemia, HTN; Diabetes Type 2, Chronic Systolic Heart Failure, Emphysema, Atrial Fibrillation	2/6/2024	M	85	<input checked="" type="checkbox"/>	<input type="checkbox"/>	<input type="checkbox"/>	<input type="checkbox"/>	<input checked="" type="checkbox"/>	<input type="checkbox"/>

Summary of Deaths by Decade: 39

Ages Age 90 - 99 yrs

Primary COD	Contributing Causes	Death Date	Gender	Age	Manner of Death	Tobacco	Alcohol	Diabetes	Drug
Alzheimer's Disease, Dementia	Unknown; Atrial Fibrillation, Cerebral Atherosclerosis	2/7/2024	F	96		<input type="checkbox"/>	<input type="checkbox"/>	<input type="checkbox"/>	<input type="checkbox"/>
Cerebrovascular Accident, d/t Embolism of Middle Cerebral Artery - No Hemorrhage Seen	Bilateral Carotid Artery Stenosis, Atrial Fibrillation, HTN	1/25/2024	F	93		<input type="checkbox"/>	<input type="checkbox"/>	<input type="checkbox"/>	<input type="checkbox"/>
Cholecystitis, Acute		2/29/2024	F	98		<input type="checkbox"/>	<input type="checkbox"/>	<input type="checkbox"/>	<input type="checkbox"/>
Failure to Thrive, Adult	CAD	2/20/2024	M	90		<input type="checkbox"/>	<input type="checkbox"/>	<input type="checkbox"/>	<input type="checkbox"/>
Fracture, Complications, Right Wrist & Right Hip	Fall from Standing Height; Dementia	2/16/2024	M	90	Accident	<input type="checkbox"/>	<input type="checkbox"/>	<input type="checkbox"/>	<input type="checkbox"/>
Heart Disease, Hypertensive & Kidney Disease	Major Neurocognitive Disorder, DM2, Hx of CVA	2/28/2024	M	90		<input type="checkbox"/>	<input type="checkbox"/>	<input checked="" type="checkbox"/>	<input type="checkbox"/>
Kidney Disease, Malignant Hypertensive w/CKD4	Chronic Heart Failure w/Preserved Ejection Fraction, Pulmonary HTN, Rheumatoid Arthritis	2/19/2024	F	90		<input type="checkbox"/>	<input type="checkbox"/>	<input type="checkbox"/>	<input type="checkbox"/>
Respiratory Failure, Chronic, w/ Hypoxia	Obstructive Lung Cancer; Pulmonary HTN, CHF, Peripheral Vascular Disease, Hx of Tobacco Use	2/9/2024	F	90		<input checked="" type="checkbox"/>	<input type="checkbox"/>	<input type="checkbox"/>	<input type="checkbox"/>
Sepsis	Pasteurella Cellulitis; Myelodysplastic Syndrome, Pancytopenia, Atrial Fibrillation, Diabetes Type 2, Hypothyroidism, Stage 3 CKD	2/10/2024	M	91		<input type="checkbox"/>	<input type="checkbox"/>	<input checked="" type="checkbox"/>	<input type="checkbox"/>
Undetermined Natural Causes	Alzheimer's	2/6/2024	F	92		<input type="checkbox"/>	<input type="checkbox"/>	<input type="checkbox"/>	<input type="checkbox"/>
Undetermined Natural Causes	Hypertensive Heart & Kidney Disease w/o Heart Failure & w/CKD Stage 5, CAD involving Native Coronary Artery	2/18/2024	M	91		<input checked="" type="checkbox"/>	<input type="checkbox"/>	<input type="checkbox"/>	<input type="checkbox"/>
Vascular Dementia	Cerebrovascular Disease	2/6/2024	F	97		<input type="checkbox"/>	<input type="checkbox"/>	<input type="checkbox"/>	<input type="checkbox"/>
Vascular Dementia	Hyperlipidemia & Essential HTN	2/27/2024	F	93		<input type="checkbox"/>	<input type="checkbox"/>	<input type="checkbox"/>	<input type="checkbox"/>

Summary of Deaths by Decade: 13

Ages Age 100 - 109 yrs

Primary COD	Contributing Causes	Death Date	Gender	Age	Manner of Death	Tobacco	Alcohol	Diabetes	Drug
Aortic Stenosis	Atrial Fibrillation	2/9/2024	F	101		<input type="checkbox"/>	<input type="checkbox"/>	<input type="checkbox"/>	<input type="checkbox"/>

Gastrointestinal Bleed, Hemorrhage	Atrial Fibrillation, Acute Blood Loss	2/17/2024	F	100	<input type="checkbox"/>	<input type="checkbox"/>	<input type="checkbox"/>	<input type="checkbox"/>
	Anemia, Dementia				<input type="checkbox"/>	<input type="checkbox"/>	<input type="checkbox"/>	<input type="checkbox"/>
Heart Disease, Hypertensive w/Reduced Ejection Fraction	DM Type 2, Cerebral Atherosclerosis, Transient Ischemic Attacks	2/1/2024	F	100	<input type="checkbox"/>	<input type="checkbox"/>	<input checked="" type="checkbox"/>	<input type="checkbox"/>

Summary of Deaths by Decade: 3

Total of All Deaths is 110

Tobacco Related:	26	23.64%
Alcohol Related:	5	4.55%
Diabetes Related:	23	20.91%
Drug Related:	0	0.00%

LINN COUNTY ENVIRONMENTAL HEALTH			
MONTHLY ACTIVITY REPORT			
FISCAL YEAR			
2023-2024			
FOR MONTH OF FEBRUARY			
	THIS	YEAR TO	PREVIOUS
	MONTH	DATE	YTD
ON-SITE SEWAGE DISPOSAL			
Site Evaluation Applications	6	62	54
Permit Applications			
New	1	46	55
Alterations/Remodels/Replacements	2	23	29
Repair	3	52	25
Renewal/Transfer	0	3	10
Authorization to Connect Applications	6	45	40
Plan Review Applications on Existing Systems	0	0	5
Precovers Requested	11	162	185
Precovers Waived	0	2	2
Septic Pumper Truck Inspections	0	2	1
Operations & Maintenance Log Reviews	136	217	358
Complaints Received	1	8	11
LICENSED FACILITIES			
Food Service Facilities			
Routine Inspections	13	197	376
School Kitchens	3	59	59
Mobiles/Commissaries	4	101	107
Follow-up Inspections	12	95	209
Failed to Comply	0	5	13
Licensed Facility Plan Reviews	3	38	27
Pre-Opening Inspections	9	36	26
Temporary Restaurants	5	78	51
Benevolent Restaurants	7	35	28
Recreational Facilities			
Organizational Camps	0	3	6
Recreational Vehicle Parks	1	13	10
Swimming Pools & Spas	7	42	32
Hotels/Motels	7	9	12
Day Cares	8	43	37
Complaints Received	6	36	38

LINN COUNTY ENVIRONMENTAL HEALTH			
MONTHLY ACTIVITY REPORT			
FISCAL YEAR			
2023-2024			
FOR MONTH OF FEBRUARY			
	THIS	YEAR TO	PREVIOUS
	MONTH	DATE	YTD
PUBLIC WATER SYSTEMS			
Routine Sanitary Surveys	7	15	16
Deficiency Follow-ups	0	6	35
Alerts	3	56	47
SOLID WASTE			
Complaints Received	0	2	6
TOTAL NET FUNDS DEPOSITED	\$42,157	\$966,696	\$954,477



Linn County Department of Health Services

PO Box 100, Albany, OR 97321
Toll Free (800) 304-7468 | TTY/Oregon (800) 735-2900
www.linncountyhealth.org

"Working together to promote the health and well-being of all Linn County residents"

Board Summaries for March 19, 2024

Alcohol & Drug Numbers

February 2024

- Total Clients Seen 242
- Total Visits 1853
 - Individual sessions – 233
 - Group Sessions – 1620

R&O 2024-058

This is an Intergovernmental Agreement between Linn County and Oregon Health Authority for Intoxicated Driver Program Fund. This provides Linn County with a \$140,116.00 to provide individuals who have been adjudicated in an Oregon court for Driving under the Influence of Intoxicants. This agreement is effective from January 1, 2024 to June 30, 2025.

R&O 2024-063

This is a Person Services Contract between Linn County and ABC House to provide victim support services. This funding is provided as a pass through grant from the Criminal Justice Commission, Justice Reinvestment Program with a not to exceed amount of \$87,924.50. This contract is effective from July 1, 2023 to June 30, 2025.

R&O 2024-064

This is a Person Services Contract between Linn County and CARDV to provide victim support services. This funding is provided as a pass through grant from the Criminal Justice Commission, Justice Reinvestment Program with a not to exceed amount of \$87,924.50. This contract is effective from July 1, 2023 to June 30, 2025.

R&O 2024-065

This is an Intergovernmental Agreement between Linn County and Oregon Health Authority for Parent Child Interaction Therapy Services (PCIT). This provides Linn County with a \$100,029.00 to provide individuals who have been adjudicated in an Oregon court for Driving under the Influence of Intoxicants. This agreement is effective from January 1, 2024 to June 30, 2025.

Administration	Alcohol & Drug Treatment	Developmental Disabilities	Environmental Health	Mental Health	Public Health
M(541) 967-3888 F(541) 924-6904 tnoble@co.linn.or.us	M(541) 967-3819 F(541) 967-7259 ithomas@co.linn.or.us	M(541) 967-3890 F(541) 924-6905 ccliburn@co.linn.or.us	M(541) 967-3821 F(541) 924-6904 ssanderson@co.linn.or.us	M(541) 967-3866 F(541) 928-3020 tthompson@co.linn.or.us sminta@co.linn.or.us	M(541) 967-3888 F(541) 926-2102 ssanderson@co.linn.or.us

LINN COUNTY EXPO CENTER



Facility Activity Report February 2024

About our facility

From a distance, dramatic white peaks suspended above the entrance to the Linn County Expo Center resemble the grace of the Cascade Range. It's a striking visual reference to the Willamette Valley and the Pacific Northwest.

At the center of it all is the Linn County Expo Center. With over 157,000 square feet of versatile convention and exhibit space, this flexible modern meeting facility in Albany, Oregon was designed to host an array of meetings, conventions and exhibitions. We are a showplace in the valley with a heart for agriculture and livestock. With easy access off I-5, adjacent hotels and restaurants, we make event planning simple.

Willamette Conference Center

With over 6,000 square feet of versatile conference space, the Willamette Conference Center boasts both modern and high-tech amenities, from free wireless internet and state of the art audio and video equipment to an attached commercial kitchen, all designed to make you stand out from the crowd.

Phone: 541-926-4314 | Fax: 541-926-8630

www.lcfairexpo.com



FEBRUARY ACTIVITY REPORT

REVENUE -

February collected revenue \$80,504
 2023/2024 - FYTD \$691,730
 Outstanding YTD invoices: \$7,272

LARGE FEBRUARY EVENTS -

Hell on Hooves Rough Stock Rodeo	February 3 rd
Linn County Small Woodlands Seeding Sale	February 3 rd
Willamette Sportsman Show	February 9 th - 11 th
Oregon Highschool Equestrian Team Meet	February 16 th - 18 th
Linn County Kennel Club AKC Dog Show	February 23 rd - 25 th

FEBRUARY EVENT REVENUE -

\$95,887.69

PERSONNEL -

Personnel Costs \$75,235

MATERIALS AND SUPPLIES -

Materials & Supplies Cost \$48,258

LARGE MARCH EVENTS -

Albany Rifle and Pistol Club Gun Show	March 2 nd - 3 rd
Roller Derby	March 2 nd
Northwest Fly Tyer Expo	March 8 th - 10 th
Oregon Highschool Equestrian Team Meet	March 8 th - 10 th
Oregon Meet Processors Convention	March 15 th - 16 th
Oregon Highschool Equestrian Team Meet	March 15 th - 17 th
Linn County Flea Market	March 16 th
Northwest Horse Fair and Expo	March 22 nd - 24 th
Rocky Mountain Elk Foundation Banquet	March 30 th

LARGE APRIL EVENTS -

Chintimini Kennel Club Dog Show	April 3 rd - 7 th
Cascade to Coast Short School	April 9 th - 11 th
North Valley OHSET Horse Show	April 11 th - 14 th
Oregon Schools Facility Conference	April 16 th - 18 th
Willamette Valley OHSET Show	April 18 th - 21 st
Oregon Women for AG Banquet	April 20 th
Yokai Market	April 19 th - 20 th
Blackberry Junction Home Decor Sale	April 22 nd - 27 th
Heart of the Valley Home Show	April 24 th - 29 th
Linn County 4-H Field Days	April 29 th - May 5 th



COMMISSIONER UPDATE

YEAR TO DATE FINANCIALS - 2023/2024

Revenue Comparison		21/22	22/23	23/24	Up/Down	
	July	\$ 4,413.00	\$ 42,060.00	\$ 12,205.00	\$ (29,855.00)	
23/24 Budget	August	\$ 17,219.00	\$ 92,921.00	\$ 49,018.00	\$ (43,903.00)	
\$ 923,000.00	September	\$ 20,573.00	\$ 45,796.00	\$ 57,626.00	\$ 11,830.00	
76,917	October	\$ 33,627.00	\$ 103,347.00	\$ 135,045.00	\$ 31,698.00	
	November	\$ 45,110.00	\$ 60,497.00	\$ 124,096.00	\$ 63,599.00	
	December	\$ 86,525.00	\$ 51,557.00	\$ 71,386.00	\$ 19,829.00	
	January	\$ 20,951.00	\$ 126,622.00	\$ 161,850.00	\$ 35,228.00	
	February	\$ 114,140.00	\$ 114,775.00	\$ 80,504.00	\$ (34,271.00)	
	March	\$ 88,511.00	\$ 129,911.00			
	April	\$ 21,280.00	\$ 102,580.00			
	May	\$ 94,020.00	\$ 135,727.00			
	June	\$ 81,023.00	\$ 62,458.00			
		\$ 627,392.00	\$ 1,068,251.00	\$ 691,730.00	\$ 54,155.00	Balance Remaining
						\$ 231,270.00

M & S Comparison		21/22	22/23	23/24	Up/Down	
	July	\$ 21,535.00	\$ 40,401.00	\$ 49,914.00	\$ 9,513.00	
23/24 Budget	August	\$ 17,723.00	\$ 22,250.00	\$ 46,718.00	\$ 24,468.00	
\$ 622,900.00	September	\$ 39,674.00	\$ 63,611.00	\$ 55,623.00	\$ (7,988.00)	
51,908	October	\$ 35,991.00	\$ 41,395.00	\$ 30,829.00	\$ (10,566.00)	
	November	\$ 28,156.00	\$ 58,842.00	\$ 79,059.00	\$ 20,217.00	
	December	\$ 39,041.00	\$ 73,043.00	\$ 59,067.00	\$ (13,976.00)	
	January	\$ 22,163.00	\$ 52,010.00	\$ 51,148.00	\$ (862.00)	
	February	\$ 31,219.00	\$ 41,587.00	\$ 48,258.00	\$ 6,671.00	
	March	\$ 39,991.00	\$ 66,132.00			
	April	\$ 95,764.00	\$ 70,154.00			
	May	\$ 57,616.00	\$ 71,451.00			
	June	\$ 49,408.00	\$ 45,226.00			
		\$ 478,281.00	\$ 646,102.00	\$ 420,616.00	\$ 27,477.00	Balance Remaining
						\$ 202,284.00

Personnel Services		21/22	22/23	23/24	Up/Down	
	July	\$ 56,296.00	\$ 59,591.00	\$ 53,063.00	\$ (6,528.00)	
23/24 Budget	August	\$ 75,245.00	\$ 67,335.00	\$ 61,915.00	\$ (5,420.00)	
\$ 1,046,280.00	September	\$ 63,874.00	\$ 60,752.00	\$ 54,000.00	\$ (6,752.00)	
87,190	October	\$ 72,677.00	\$ 63,942.00	\$ 62,187.00	\$ (1,755.00)	
	November	\$ 72,680.00	\$ 70,601.00	\$ 49,151.00	\$ (21,450.00)	
	December	\$ 106,033.00	\$ 96,753.00	\$ 66,131.00	\$ (30,622.00)	
	January	\$ 53,814.00	\$ 47,007.00	\$ 74,213.00	\$ 27,206.00	
	February	\$ 56,600.00	\$ 47,971.00	\$ 75,234.69	\$ 27,263.69	
	March	\$ 55,005.00	\$ 47,381.00			
	April	\$ 53,238.00	\$ 49,332.00			
	May	\$ 54,545.00	\$ 51,093.00			
	June	\$ 56,215.00	\$ 47,555.00			
		\$ 776,222.00	\$ 709,313.00	\$ 495,894.69	\$ (18,057.31)	Balance Remaining
						\$ 550,385.31



Linn County Fair & Expo
3700 Knox Butte Rd
Albany, OR 97322
Phone: 541-926-4314 Fax: 541-926-8630

FEBRUARY EVENT REVENUE

Start Date	Book #	Contract #	Client	Revenue
2/14/2024	6481		OHSET- Willamette District	\$10,272.00
2/2/2024	6621		Wild West Events	\$2,695.00
2/1/2024	6941		Linn County Road Department	\$0.00
2/6/2024	6953		Helena Agri-Enterprises, LLC	\$440.00
2/6/2024	6990		SSGWO / OSU Extension	\$480.00
2/12/2024	7013		Linn County Sheriffs Office	\$0.00
2/7/2024	7024		Jefferson Baptist Church	\$26,837.50
2/16/2024	7029		Mule Deer Foundation	\$1,780.00
2/21/2024	7106		Linn County Kennel	\$51,493.01
2/17/2024	7110		Oregon High School Robotics Competition	\$1,690.13
2/5/2024	7131		Greater Albany Rotary Club	\$0.00
2/12/2024	7133		Linn County Commissioners	\$0.00
2/5/2024	7135		Albany Visitors Association	\$0.00
2/6/2024	7157		Linn County Sheriffs Office	\$0.00
2/6/2024	7161		Benton County	\$0.00
2/29/2024	7168		Resource Connections of Oregon	\$200.00
2/23/2024	7183		Air Force National Guard	\$0.00
2/24/2024	7184		Air Force National Guard	\$0.00
2/25/2024	7185		Air Force National Guard	\$0.00
				\$95,887.69



Linn County Fair & Expo
 3700 Knox Butte Rd
 Albany, OR 97322
 Phone: 541-926-4314 Fax: 541-926-8630

March 2024

Sunday	Monday	Tuesday	Wednesday	Thursday	Friday	Saturday
3 Albany Rifle & Pistol Club - Gun Show 7163 Black Sheep Gathering Spring Meeting 7164	4 Weekly Rotary Meeting 6961	5 (BNJ) ALBANY BUSINESS BUILDERS - MONTHLY MEETING 7018 Dog Classes 7028	6 AMAZON DRIVER TRAINING 7098 Local Budget Law Training 7092	7 AMAZON DRIVER TRAINING 7098 Northwest Fly Tyer & Fly Fishing Expo 7047	8 DSA BANQUET NEEDS 7198 Northwest Fly Tyer & Fly Fishing Expo 7047	9 DSA BANQUET NEEDS 7198 Northwest Fly Tyer & Fly Fishing Expo 7047
10 DSA BANQUET NEEDS 7198 MID-WINTER 2024 PLANNING MEETING 6414	11 4H Practice 7149 DSA BANQUET NEEDS 7198 Fair Board Meeting 7073	12 Dog Classes 7028 DSA BANQUET NEEDS 7198 Linn Sheriff's Office Training 7014	13 AMAZON DRIVER TRAINING 7098 DSA BANQUET NEEDS 7198	14 AIM Leadership Academy 7194 AMAZON DRIVER TRAINING 7098	15 Linn County Flea Market 6844 Linn Sheriff's Office Training 7014	16 Linn County Flea Market 6844 MEAT PROCESSORS CONVENTION 6539
17 OHSET North Valley - Horse Show 6879	18 Linn County Republican Party Central Committee Meeting 7083 Linn Sheriff's Office Training 7193	19 4H Practice 7150 Linn Sheriff's Office Training 7014	20 Chamber Forum Lunch 6773 Linn Sheriff's Office Training 7014 Northwest Horse Fair & Expo 7141	21 Linn Sheriff's Office Training 7014 Linn Sheriff's Office Training 7193 Northwest Horse Fair & Expo 7141	22 Linn Sheriff's Office Training 7014 Linn Sheriff's Office Training 7193 Northwest Horse Fair & Expo 7141	23 Northwest Horse Fair & Expo 7141
24 Northwest Horse Fair & Expo 7141	25 Weekly Rotary Meeting 6961	26 Dog Classes 7128 Linn County Tour Demonstration Master Garden 7080	27 AMAZON DRIVER TRAINING 7098 Drill Day 7197	28 AIM Leadership Academy 6940 AMAZON DRIVER TRAINING 7098	29 Market For The Strange 7113 Scio OHSET Practice 7076	30 Heart of the Valley Big Game Banquet 6891 JOEL SANNAN LAST DAY 7152
31 Cascade High School Practice 7146						



Linn County Fair & Expo
 3700 Knox Butte Rd
 Albany, OR 97322
 Phone: 541-926-4314 Fax: 541-926-8630

April 2024

Sunday	Monday	Tuesday	Wednesday	Thursday	Friday	Saturday
7 Chintimini Kennel Club - Dog Show 7043	1 Joint Emergency Management Training 7108 Weekly Rotary Meeting 6961	2 (BNI) ALBANY BUSINESS BUILDERS - MONTHLY MEETING 7018 Joint Emergency Management Training 7108	3 Chintimini Kennel Club - Dog Show 7043 Elected Officials Meeting 7049 Joint Emergency Management Training 7108	4 Chintimini Kennel Club - Dog Show 7043 Joint Emergency Management Training 7108	5 Chintimini Kennel Club - Dog Show 7043 Joint Emergency Management Training 7108	6 Chintimini Kennel Club - Dog Show 7043
8 Fair Board Meeting 7073 Weekly Rotary Meeting 6961	9 Cascade to Coast Short School 6817 Dog Classes 7128	10 Cascade to Coast Short School 6817	11 Cascade to Coast Short School 6817 OHSET North Valley - Horse Show 6103	12 OHSET North Valley - Horse Show 6837 RaSani Fair 6103	13 OHSET North Valley - Horse Show 6837 RaSani Fair 6103	
14 OHSET North Valley - Horse Show 6837 RaSani Fair 6103	15 Linn County Republican Party Central Committee Meeting 7083 Sweet Home OHSET Practice 6914	16 Dog Classes 7128 OHSET Willamette District Practice Ride 6908 OSFMA Convention 7190	17 LINN COUNTY POSSEE PRACTICE RIDE 7061 OSFMA Convention 7190	18 OHSET - Willamette District 6907 OSFMA Convention 7190	19 OHSET - Willamette District 6907 Oregon Women for Agriculture Auction and Dinner 7144	20 OHSET - Willamette District 6907 Oregon Women for Agriculture Auction and Dinner 7144 Shred Day 7070
21 FMCA Planning Meeting 6705 NEED PIPE AND DRAPE SET AT SYBARIS - SEE KRIS 7186 OHSET - Willamette District 6907	22 FMCA Planning Meeting 6705 OSU FEED CLINIC 7191 Sale - Blackberry Junction 6851 Weekly Rotary Meeting 6961	23 4H Practice 7150 FMCA Planning Meeting 6705 Sale - Blackberry Junction 6851	24 Chamber Forum Lunch 6773 FMCA Planning Meeting 6705 Heart of the Valley Home & Garden Show 6849	25 All Staff Meeting 7151 Heart of the Valley Home & Garden Show 6849 Sale - Blackberry Junction 6851	26 Heart of the Valley Home & Garden Show 6849 Sale - Blackberry Junction 6851	27 Heart of the Valley Home & Garden Show 6849 Sale - Blackberry Junction 6851
28 Heart of the Valley Home & Garden Show 6849 LIVESTOCK (BEEF) DAY 7085	29 Heart of the Valley Home & Garden Show 6849 LCYLA Field Days 7159 Linn County Budget Hearing 7071	30 4H Practice 7150 Dog Classes 7128 LCYLA Field Days 7159 ROGA Practice 7025				



LINN COUNTY PROPERTY MANAGEMENT
104 SW 4th Avenue, Room 123 Albany, Oregon 97321
Phone: (541) 967-3807

Date: March 19, 2024
To: Board of Commissioners
From: Rachel Adamec, Real Property Program Manager
RE: Sealed Bid Opening Continued - Property Account #216305

Property Management received one sealed bid for property account #216305 (12S-2W-25A-1601).
Property history/details:

Address: 1730 Cascade Dr., Lebanon
Foreclosure Date: December 13, 2022
Auction Date: August 9, 2023
Minimum Bid @ Auction: \$58,275
RMV: \$129,910
Sealed Bid Minimum: \$39,900
Taxlot Size: .26 acre
Zoning: RR-2.5





Linn County Road Department

*Providing safe and efficient transportation to
citizens and visitors of Linn County.*

Memorandum

Date: 3/14/2024

To: Linn County Board of Commissioners

From: Wayne Mink, Roadmaster *WEM*

RE: Background Information for Agenda Items – 3/19/2024

The Road Department has the following items on the Board of Commissioners agenda for the weekly meeting on March 19, 2024. The following is a brief description of the items.

Resolution & Order 2024-086 – Delegation of Authority, Oil Rock Purchase

This is a Resolution & Order to approve a delegation of authority to the Roadmaster for the purchase of oil rock for the Mill City area surface treatment projects. This purchase is from Knife River in the amount of \$115,590.

Resolution & Order 2024-087 – Delegation of Authority, Oil Rock Purchase

This is a Resolution & Order to approve a delegation of authority to the Roadmaster for purchase of oil rock for the 2024 chip seal project. This purchase is from Knife River for the delivery to the Scio Maintenance District in the amount of \$115,668.75.

Resolution & Order 2024-088 – Delegation of Authority, Oil Rock Purchase

This is a Resolution & Order to approve a delegation of authority to the Roadmaster for purchase of oil rock for the 2024 chip seal project. This purchase is from Knife River for the delivery to the Sweet Home stockpile location in the amount of \$201,675.

We request your approval.

LINN COUNTY TREASURER



MICHELLE HAWKINS
Treasurer
mhawkins@co.linn.or.us

BREEANNA OXFORD
Chief Deputy Treasurer
boxford@co.linn.or.us

*Linn County Courthouse
P.O. Box 100, Albany, Oregon 97321
(541) 967-3861 FAX: (541) 926-8228*

To: Board of Commissioners

From: Linn County Treasurer/Budget Officer

Date: March 19th, 2024

Re: Order # 2024-114

Order # 2024-114 is a transfer within the Grants Fund in the amount of \$2,600,000 from Operating Contingency to Capital Real Property for the purchase of a building for the Health Department.

Financial Impact. There is no financial impact.

LINN COUNTY BOARD OF COMMISSIONERS HEARING STAFF REPORT

PREPARED BY: Alyssa Boles, Planning Manager

DATE ISSUED: March 12, 2024

HEARING DATE: March 19, 2024

APPLICATION: **PD23-0743**: an application by Talon Henness for a Comprehensive Plan Map amendment and Zoning Map amendment on a 1.00-acre property identified as Tax Lot 401 on map T10S, R03E, Section 00. The applicant proposes to amend the Plan designation from Forest Resource to Farm/Forest and the Zoning map designation from Forest Conservation Management (FCM) to Farm/Forest (F/F).

PLAN / ZONE: Forest Resource / Forest Conservation Management (FCM)

LOCATION: The property is located on the south side of Pebble Drive, approximately 0.25 miles east of the intersection of Pebble Drive and Rock Creek Road, and approximately 1.79 miles southeast of the city of Mill City.

CRITERIA: Linn County Land Development Code (LCC) 921.822(A) and 921.874 and Oregon Administrative Rules (OAR) 660-006-0057 contain the applicable decision criteria.

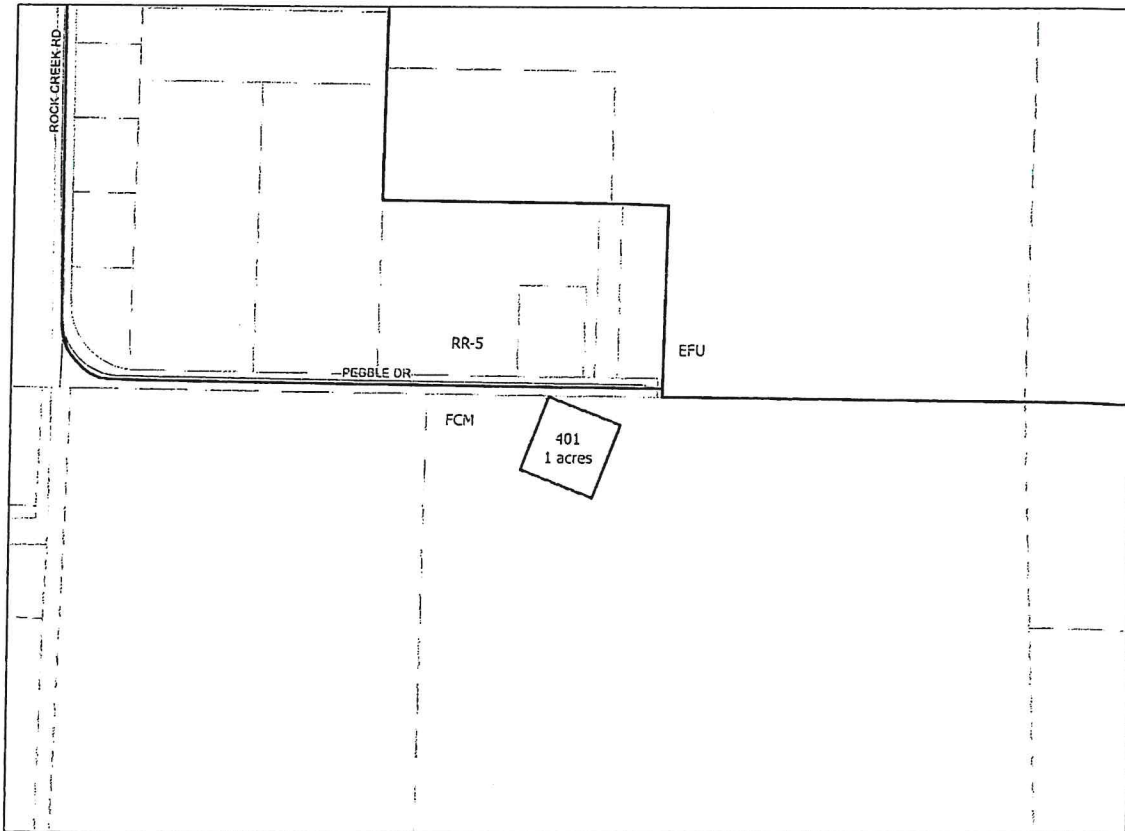

1:3,600

Linn County Planning & Building Department

Date: .

I. INTRODUCTION

A. APPLICATION SUMMARY

Talon Henness (Applicant) is proposing to change the Comprehensive Plan Map designation and *Zoning Map* designation on a 1.00-acre property from Forest Conservation Management (FCM) to Farm Forest (F/F). The subject property is identified on Linn County Assessor maps as T10S, R03E, Section 00, Tax Lot 401. The property is located on the south side of Pebble Drive, approximately 0.25 miles east of the intersection of Pebble Drive and Rock Creek Road, and approximately 1.79 miles southeast of the city of Mill City.

The *Comprehensive Plan (Plan)* designation of the property is Forest Resource. Statewide Planning Goal 4 currently applies to the subject property. Goals 3 and 4 apply to properties with a Farm/Forest Plan and zoning designation; therefore, the proposed amendments do not require an exception to Statewide Planning Goal 3 or Goal 4.

The application indicates that the purpose of the zoning map amendment is to be able to timber the property. The application indicates that the applicant may want to build a dwelling on the property at some point. The F/F zoning district does not allow for a dwelling as an outright use. An application for a dwelling would have to meet the applicable criteria contained in Linn County Code. This zoning map amendment does not authorize the placement of a dwelling on the subject property.

The applicant must provide evidence that the proposal is consistent with the decision criteria, including all applicable Comprehensive Plan policies. The application is attached to this report as **Exhibit A**.

B. PLANNING COMMISSION RECOMMENDATION

The Planning Commission (Commission) will hold a public hearing on this matter at 7:00 p.m., March 12, 2024. The Commission will vote on a recommendation to the Board regarding this matter at the hearing. The Board is scheduled to conduct a public hearing on this matter at 10:00 a.m., Tuesday, March 19, 2024. The Commission recommendation will be available at the Board hearing.

C. DECISION CRITERIA AND ANALYSIS

The applicable decision criteria are contained in LCC Sections 921.822(A) and 921.874 and Oregon Administrative Rules (OAR) 660-006-0057. The decision criteria are attached to this report as **Exhibit B**.

LCC 921.822 Decision criteria for Zoning Map amendments

(A) When a Zoning Map or Land Development Code text amendment is necessary due to a proposed *Comprehensive Plan* amendment, only findings and conclusions responding to the *Comprehensive Plan* amendment criteria for decision are necessary to amend the Zoning Map or Code text provisions.

STAFF ANALYSIS: Both a Zoning map amendment and a *Plan* map amendment are proposed with this application. The *Plan* amendment criteria described in 921.874 are addressed above. Compliance with the *Plan* Amendment criteria satisfies this criterion.

LCC 921.874(A) - Decision criteria for Plan map amendments

(A) To approve a Plan map amendment, findings shall be made that:

(1) The amendment is consistent with and does not alter the intent of applicable section (s) of the Comprehensive Plan;

STAFF ANALYSIS: The following policies in the Land Use Element (Chapter 905) of the Comprehensive Plan apply to the proposed amendments:

LCC 905.220(B) (Policies for forest resource lands):

(B) Forest Resource lands will be kept in large tracts to ensure forestry can occur and the land is being used for its intended purposes. The minimum lot size is set by statute to ensure the land base continues to be suitable for forestry production. The partition and property line adjustment sections of the LCC establish standards for reducing the size of a parcel and creating new parcels.

The subject property is not consistent with this policy because it is one acre in size and is not large enough to support commercial forestry production.

LCC 905.300(D - E) (Farm/Forest lands; background)

(D) Given that the Farm/Forest designation is a hybrid of agriculture and forestry uses, Statewide Planning Goals 3 and 4 apply to these lands. Farm/Forest lands aim to preserve and maintain agricultural and forest lands and to conserve soil, water, air and wildlife resources. Resource land uses permitted in both the EFU and the FCM zones are allowed in the Farm/Forest zone given the same regulations that exist in the other resource zones. Uses permitted conditionally in either the Agricultural or Forest Resource plan designation are also permitted conditionally in the Farm/Forest zone under similar regulations.

The F/F zoning district supports uses similar to the current FCM zoning designation. Either farm or forest uses are suitable on this property given its location and topography. LCC 905.300(E) identifies the foothills of Linn County as the primary location of Farm/Forest zoning. Linn County Geographic Information System (GIS) maps indicate the subject property is located in the foothills of the County. Under LCC 905.300(B), typical land uses in the Farm/Forest area include farming, livestock grazing and small scale-timber operations. The topographical features, soil and natural features of the subject property are consistent with the provisions described in LCC 905.300 (Farm/Forest Background).

The existing zoning on the south side of Pebble Drive is Forest Conservation Management (FCM). The existing zoning on the north side of Pebble Drive transitions west to east from Rural Residential to Exclusive Farm Use. The existing land use pattern in the area transitions from dwellings and forest land in the west to small scale timber processing and less intensive farm uses in the surrounding FCM and EFU zoned areas, to state and federally managed forest land in the FCM zoned areas surrounding the subject property. Linn County GIS aerial photography indicates that the historic land use pattern in the area is a mix of agricultural and forest uses, adjacent to some low density residential areas containing small scale hobby farms. The application indicates that the purpose of the zoning map amendment is to be able to timber the property. The proposed small-scale timber operation appears to be consistent with surrounding land uses in the area.

(E) The Farm/Forest lands of Linn County are located primarily in the foothills of Linn County while the EFU and the FCM lands are typically concentrated in the western and eastern areas of the county respectively. Though Farm/Forest lands are a hybrid of the other two resource designations of the Comprehensive Plan, the nature of Farm/Forest lands makes regulation of them different and perhaps more difficult than the other zones. The mixed-use Farm/Forest zone is characterized by smaller parcel sizes and more residential development. Though there is an eighty-acre minimum size for new properties in the Farm/Forest designation, many properties were created at a smaller size under previous zoning laws or prior to the initiation of zoning laws.

The subject property is more aligned with this policy, rather than LCC 905.220(B). It is a small acreage property adjacent to residential development.

(2) The amendment will be compatible with adjacent uses and will not adversely impact the overall land use pattern in the area;

FACTS: Linn County GIS maps indicate the subject property is contiguous to properties with a Forest Conservation Management zoning designation to the south, west, and east and contiguous to properties with a Rural Residential and Exclusive Farm Use zoning designation to the north.

STAFF ANALYSIS: The application states that the proposed zoning designation would be consistent with surrounding properties. The proposed F/F zoning designation would provide for both farm and forest uses. The topographical features, soil and natural features of the subject property are consistent with the provisions described in LCC 905.300 (Farm/Forest Background).

The F/F zoning district also supports uses similar to the current FCM zoning designation. Either farm or forest uses are suitable on this property given its location and topography. LCC 905.300(E) identifies the foothills of Linn County as the primary location of Farm/Forest zoning. Linn County Geographic Information System (GIS) maps indicate the subject property is located in the foothills of the County. Under LCC 905.300(B), typical land uses in the Farm/Forest area include farming, livestock grazing and small scale-timber operations.

The existing zoning in the area from west to east is Forest Conservation Management (FCM). The existing zoning north of the property from west to east transitions from Rural Residential to Exclusive Farm Use. The existing land use pattern in the area transitions west to east from dwellings and privately managed timber land and farm fields to commercial timber operations in the FCM zoned areas south and east of the property.

Notice was sent to surrounding property owners within 1,000 feet of the subject property. No comments were submitted indicating any adverse impacts to the land use pattern in the area a result of the proposed amendments.

The proposed zoning map amendment does not authorize specific development. Any proposed future development would be subject to a land use review and criteria to determine if there are impacts to surrounding farm and forest uses, as well as determine whether any proposed development will have any adverse impacts on the overall land use pattern in the area.

- (3) The amendment, if within an adopted urban growth boundary, is in substantial conformity with the *Comprehensive Plan* and implementing ordinances of an affected city;**

STAFF ANALYSIS: The subject property is not located within an urban growth boundary; therefore, this criterion is not applicable.

- (4) The amendment will not have a significant adverse impact on a sensitive fish or wildlife habitat;**

FACTS: The property is located within an inventoried peripheral big game habitat area. The property does not contain any inventoried sensitive fish or riparian habitat. There is an inventoried wetland on the property.

STAFF ANALYSIS: The subject property is located within a peripheral big game habitat area (**Exhibit C**). The property is located within Section 00 of T10S, R1E, in Linn County, Oregon. The section (Section 00) is developed with one existing dwelling. Pursuant to LCC 903.510(B)(2), Section 26 is not "impacted".

There are no sensitive fish or riparian habitats on the property. Oregon Department of Fish and Wildlife was notified of the proposed amendments submitted comments stating that the amendments could result in a possible dwelling or structures on the property, which could have potential impacts to wildlife habitat (**Exhibit D, pages 5-6**).

The amendment applications, if approved, do not grant dwelling approval. If a dwelling or structure is proposed in the future, pursuant to LCC 903.510(B)(10) (Policies for fish and wildlife areas and habitat), clustering techniques (for new dwellings) shall be used to implement the ODFW acceptable density standard in the major and peripheral game ranges. Clustering means all of the following as applicable to the situation: (a) Locating dwellings and structures near each other and existing roads; (b) Locating dwellings and structures to avoid habitat conflicts and utilize least valuable habitat areas; and (c) Minimize road development to that necessary to support the residential use. Future development within the peripheral big game habitat area is required to comply with the clustering techniques described in the *Plan*.

Surrounding lands to the east, west, and south are zoned Forest Conservation management, which does not permit a dwelling. The surrounding lands are primarily state and federally managed forest land. Development within the section is limited by the zoning district. Aerial imagery indicates that the surrounding lands have historically been managed for timber production or forest preservation.

- (5) The amendment will not have a significant adverse impact upon the provision of public facilities including police and fire protection, sanitary facilities and storm drainage facilities;**

FACTS: The property is located within the Gates Rural Fire Protection District. The subject property is served by the Linn County Sheriff's Office. The property does not contain a septic system.

STAFF ANALYSIS: The subject property is located within the Gates Rural Fire Protection District. The Linn County Sheriff's Department received notice of the application and did submit comments expressing any concern as a result of the proposed amendments.

If the property were to be developed at a future date, Linn County Code requires compliance with LCC 934.590 (F/F (forest area) and FCM zoning district structural siting standards). The provisions in LCC 934.590 require that the property be either: (1) located within a fire protection district, (2) shall be provided with structural fire protection by contract, or (3) provide an alternative means for protecting the structure from fire hazards, such as sprinkling systems or on-site water storage.

Septic suitability is generally not factors in determining whether the property is appropriate for an F/F Plan and zoning designation. Linn County Environmental Health Program did not submit comments indicate impacts regarding septic suitability as a result of the proposed amendments. The applicant submitted septic records for surrounding properties to demonstrate septic suitability within the area.

The proposed zoning map amendment does not authorize specific development. Any proposed future development would be subject to a land use review and criteria to determine if there are impacts to transportation facilities, police and fire protection, storm drainage facilities or other regional public facilities.

(6) The amendment will not have a significant adverse impact upon the transportation facilities;

FACTS: The property has access of Pebble Drive, a County maintained right of way.

STAFF ANALYSIS: The property has access via Pebble Drive, a County maintained right of way. The Linn County Road Department was notified of the application and did not express concern regarding the proposed amendments (**Exhibit D, pages 1-2**). The Road Department comments did not indicate any significant adverse impacts to the existing road network as a result of the proposed amendments.

(7) The presence of any development limitations including geologic hazards, flood hazards or water quality or quantity will not have a significant adverse affect on land uses permitted through the amendment;

FACTS: The property is not located within a mapped geologic hazard area or within the special flood hazard area. The property does not contain a septic system or well.

STAFF ANALYSIS: The subject property is not within a designated flood hazard area. The property is not identified as being within an identified area subject to mass movement topography, as inventoried in the Environmental Geology of Western Linn County, Oregon (DOGAMI, 1974).

Water availability and water quality are generally not factors in determining whether the property is appropriate for an F/F Plan and zoning designation. The applicant also submitted well logs for surrounding properties to demonstrate water availability within the area.

(8) An exception to the statewide planning goals is not required. If required, then findings have been prepared to meet the exception criteria; and

STAFF ANALYSIS: The property currently has a Plan designation of Forest Resource and a zoning designation of Forest Conservation Management (FCM). The proposed amendments would result in a Plan designation and zoning designation of Farm/Forest.

The Farm/Forest designation is a hybrid of agriculture and forestry uses, Statewide Planning Goals 3 and 4 apply to these lands. Farm/Forest lands aim to preserve and maintain agricultural and forest lands and to conserve soil, water, air and wildlife resources. Resource land uses permitted in both the EFU and the FCM zones are allowed in the Farm/Forest zone given the same regulations that exist in the other resource zones. Uses permitted conditionally in either the Agricultural or Forest Resource plan designation are also permitted conditionally in the Farm/Forest zone under similar regulations.

As determined in LCC 921.874(A)(9) below, the application is consistent with the statewide planning goals; therefore, a goal exception is not required.

(9) The amendment is consistent with the statewide planning goals.

STAFF ANALYSIS:

Goal 1: Citizen Involvement. The proposal will be reviewed during public hearings before the Linn County Planning Commission and the Linn County Board of Commissioners. The hearings will provide opportunity for citizen involvement. Notice of the hearings was provided to surrounding landowners and affected agencies in the manner specified in the Linn County Code and State law. Property owners within 1,000 feet of the subject properties and affected public agencies were provided written notice.

Goal 2: Land Use Planning. Linn County has an acknowledged Comprehensive Plan and implementing Code. The Plan and Code establish procedures to amend the Linn County Comprehensive Plan and zoning maps. The Planning and Building Department has determined the application is complete and in compliance with Chapter 921 of the Linn County Code, as demonstrated in this staff report.

Goal 3: Agricultural Lands. The subject property will be designated on the Comprehensive Plan as Farm/Forest and will have a zoning designation of Farm/Forest (F/F). The Farm/Forest designation is a hybrid of agriculture and forestry uses, Statewide Planning Goals 3 and 4 apply to these lands. Farm/Forest lands aim to preserve and maintain agricultural and forest lands and to conserve soil, water, air and wildlife resources.

Goal 4: Forest Lands. The subject property will be designated on the Comprehensive Plan as Farm/Forest and will have a zoning designation of Farm/Forest (F/F). The Farm/Forest designation is a hybrid of agriculture and forestry uses, Statewide Planning Goals 3 and 4 apply to these lands. Farm/Forest lands aim to preserve and maintain agricultural and forest lands and to conserve soil, water, air and wildlife resources.

Goal 5: Open Spaces, Scenic and Historic Areas and Natural Resources. Goal 5 requires that the County protect natural resources and lists riparian areas, fish and wildlife habitats, wetlands, mineral and aggregate sites, and scenic waterways, among other resources, as protected by Goal 5. The subject property is located within the peripheral big game habitat area.

Policies in the Linn County Comprehensive Plan, as well as criteria and development standards in the Linn County Code are adopted to minimize impacts to protected Goal 5 resources. These same processes are also in place to ensure that proposed development

within the County is reviewed in accordance with applicable local, state, and federal regulations to protect these same resources.

Goal 6: Air, Water and Land Resources Quality. The proposed amendments do not necessarily impact air, water, or land resources quality. Generally, this type of impact is reviewed at the time a development permit is submitted to the Department. Local, state, and federal agencies are notified of proposed development on a particular property during the land use review process. All local, state, and federal requirements put in place to mitigate any potential concerns regarding air, water or land resource quality must be satisfied before site development permits can be issued.

Goal 7: Areas Subject to Natural Disasters and Hazards. There are no areas subject to Natural Disasters and Hazards identified on the site. Therefore, Planning Goal 7 does not apply to this amendment.

Goal 8: Recreational Needs. Goal 8 requires the County to plan for the recreation needs of their residents and visitors. The subject property is privately owned land and is not planned for public recreational needs. Goal 8 does not apply to the proposed *Plan* and zoning map amendment.

Goal 9: Economic Development. The subject property has historically and currently been actively farmed and timbered, which provides economic opportunity for local farmers within Linn County and the potential for economic growth within the local agricultural area.

Goal 10: Housing. Goal 10 requires jurisdictions with buildable lands in urban and urbanizable areas to be inventoried and comprehensive plans shall encourage the availability of adequate numbers of needed housing units. The property is not urban or urbanizable land, therefore Goal 10 does not apply.

Goal 11: Public Facilities and Services. Goal 11 allows for planning and development of a timely, orderly and efficient arrangement of public facilities and services to serve as a framework for urban and rural development. The applicant is not proposing to establish a public facility as a result of the proposed amendments. This goal is not applicable.

Goal 12: Transportation. The Linn County Road Department was notified of the proposed map amendments and did not indicate the requirement for a transportation analysis. The Road Department comments did not indicate significant adverse impacts to the existing road network as a result of the proposed amendments.

Goal 13: Energy Conservation. Goal 13 encourages communities to look within existing urban neighborhoods for areas of potential redevelopment before looking to expand, to "recycle and re-use vacant land." The goal also directs the County to have systems and incentives in place for recycling programs. Goal 13 does not apply to the proposed *Plan* and zoning map amendment.

Goal 14: Urbanization. The subject properties are not proposed or available for urbanization. Goal 14 does not apply to this amendment.

Goal 15: Willamette River Greenway. The subject property is not located within the Willamette River Greenway. Goal 15 does not apply to this application.

Goal 16: Estuarine Resources; Goal 17: Coastal Resources; Goal 18: Beaches and Dunes. Linn County does not have any estuaries, coastal shorelines, beaches or dunes. Goals 16, 17, and 18 do not apply in Linn County.

OAR 660-006-0057 Rezoning Land to an Agriculture/Forest Zone

Any rezoning or plan map amendment of lands from an acknowledged zone or plan designation to an agriculture/forest zone requires a demonstration that each area being rezoned or replanned contains such a mixture of agriculture and forest uses that neither Goal 3 nor 4 can be applied alone.

FACTS: Linn County GIS maps indicate the subject property is contiguous to properties with a Forest Resource Management zoning designation to the west, east, and south. The properties directly to the north of the subject property are zoned Rural Residential and Exclusive Farm Use.

STAFF ANALYSIS: The application states that the proposed zoning designation would be consistent with surrounding properties. The subject property is proposed to have a *Plan* designation of Farm/Forest. LCC 905.300(D) of the *Plan* states,

"Given that the Farm/Forest designation is a hybrid of agriculture and forestry uses, Statewide Planning Goals 3 and 4 apply to these lands. Farm/Forest lands aim to preserve and maintain agricultural and forest lands and to conserve soil, water, air and wildlife resources. Resource land uses permitted in both the EFU and the FCM zones are allowed in the Farm/Forest zone given the same regulations that exist in the other resource zones. Uses permitted conditionally in either the Agricultural or Forest Resource plan designation are also permitted conditionally in the Farm/Forest zone under similar regulations."

The F/F zoning district supports uses similar to the current FCM zoning designation. Either farm or forest uses are suitable on this property given its location and topography. LCC 905.300(E) identifies the foothills of Linn County as the primary location of Farm/Forest zoning. Linn County Geographic Information System (GIS) maps indicate the subject property is located in the foothills of the County. Under LCC 905.300(B), typical land uses in the Farm/Forest area include farming, livestock grazing and small scale-timber operations. The topographical features, soil and natural features of the subject property are consistent with the provisions described in LCC 905.300 (Farm/Forest Background).

The existing zoning on the south side of Pebble Drive is Forest Conservation Management (FCM). The existing zoning on the north side of Pebble Drive transitions west to east from Rural Residential to Exclusive Farm Use. The existing land use pattern in the area transitions from dwellings and forest land in the west to small scale timber processing and less intensive farm uses in the surrounding FCM and EFU zoned areas, to state and federally managed forest land in the FCM zoned areas surrounding the subject property. Linn County GIS aerial photography indicates that the historic land use pattern in the area is a mix of agricultural and forest uses, adjacent to some low density residential areas containing small scale hobby farms. The application indicates that the purpose of the zoning map amendment is to be able to timber the property. The proposed small-scale timber operation appears to be consistent with surrounding land uses in the area.

D. EXISTING AND PROPOSED CONDITIONS

CONDITION	EXISTING	PROPOSED
Plan Designation	Forest Resource	Farm/Forest
Zone Designation	Forest Conservation Management (FCM)	Farm/Forest (F/F)
Site Location	T10S, R03E, Section 00, Tax Lot 401	Same
Access	Pebble Drive	Same
Land Use	Forest use	Same/Possible Future Dwelling

E. ZONING AND DEVELOPMENT BACKGROUND

The subject property has been zoned Exclusive Farm Forest Resource Management since September 2, 1980. The property was zoned Timber Conservation (TC) prior to September 2, 1980. No development permits or land use files are associated with the subject property.

II. PROPERTY CHARACTERISTICS

A. SOIL TYPES - The following is based upon information in the National Resources Conservation Service (NRCS), formerly the Soil Conservation Service (SCS), publication Soil Survey of Linn County Area, Oregon, July, 1987:

Soil Type	HVFL type	SCS type	% of parcel	# of acres	Cu ft/ ac/yr
KINNEY COBBLY LOAM, 20 TO 50 PERCENT NORTH SLOPES	Non	Vle	1.02%	0.01	1.91
CUMLEY SILTY CLAY LOAM, 2 TO 20 PERCENT SLOPES	Non	Vle	15.99%	0.16	26.24
BULL RUN SILT LOAM, 15 TO 30 PERCENT SLOPES	Non	Vle	82.99%	0.83	150.23
TOTAL			100%	82.98	178.38

B. TOPOGRAPHY – The property includes moderate slopes is at an elevation of 1050 feet.

C. NATURAL FEATURES AND IMPROVEMENTS – The subject property contains a seasonal stream running through the subject property.

D. NATURAL AND/OR GEOLOGIC HAZARDS - The subject property is not within a designated flood hazard area. The property is not identified as being within an identified area subject to mass movement topography, as inventoried in the Environmental Geology of Western Linn County, Oregon (DOGAMI, 1974).

III. ENVIRONMENTAL FACTORS

A. WILDLIFE HABITAT – The subject property is located within a peripheral big game habitat area (**Exhibit C**). The property is located within Section 00 of T10S, R1E, in Linn County, Oregon. The section (Section 00) is developed with one existing dwelling. Pursuant to LCC 903.510(B)(2), the section is not "impacted". The siting standards for big game habitat in LCC 934.565 are applicable for future development on this property. There are no sensitive fish or riparian habitats on the property.

- B. **WETLANDS** – The subject property contains a seasonal stream running through the subject property.

IV. AVAILABILITY OF PUBLIC FACILITIES AND SERVICES

- A. **FIRE** – The subject property is located within the Gates Rural Fire Protection District.
- B. **POLICE** - The Linn County Sheriff's Department provides police protection.
- C. **SCHOOL** - The property is in the Santiam Canyon School District, the Linn Benton Lincoln Education Service District and the Chemeketa College District.
- D. **OTHER DISTRICTS** – The property is within the 4H Extension District.
- E. **SEWAGE DISPOSAL** – The property does not contain a sewage disposal system.
- F. **WATER SUPPLY** – The property contains an existing well.
- G. **ACCESS** – The property has access off of Pebble Drive.

V. NOTICE TABLE AND PROCEDURE

A. NOTICE

Property owners within 1,000 feet of the boundaries of the property were provided notice of this application. There are nine property owners within the notification area. No comments were received from surrounding property owners regarding the proposed amendment. The following agencies have been provided notice and responded before this report was written. Written agency comments can be found in **Exhibit D**. Copies of the public notices are included in **Exhibit C**.

AGENCIES	PROVIDED	RESPONDED	AGENCIES	PROVIDED	RESPONDED
Environmental Health	x		Linn County Sheriff	x	
Linn County Assessor	x		Dept. Land Cons. & Dev.	x	
Linn County Road Dept.	x	x	Or. Dept. of Forestry	x	
Dept. State Lands	x	x	Other: Gates Airport	x	
Or. Fish & Wildlife	x	x	Dept. of Water Resources	x	
Gates RFPD	x				

B. PROCEDURE

The Planning Commission (Commission) will conduct a public hearing to review the application and will make a **recommendation** to the Linn County Board of Commissioners (Board).

The Board is scheduled to conduct a public hearing on this matter at 10:00 a.m., Tuesday, March 19, 2024. The Board may consider the application for up to 42 days from the close of the Board hearing. Tabling of the request for a period not to exceed 35 days may also

occur if the applicant consents. Specified findings, stating the reason for decision, are required in taking action on the proposed amendments.

The Board will consider all the testimony in the matter and may take action to:

1. Approve the application;
2. Deny the application; or
3. Modify the application.

All testimony and evidence must be directed toward the applicable decision criteria including applicable criteria in the plan or other land use regulations. Failure to raise an issue before the close of the record, or failure to provide statements or evidence sufficient to afford the decision maker(s) and the parties an adequate opportunity to respond to each raised issue precludes an appeal based on that issue.

Prior to the conclusion of the initial evidentiary hearing, any participant may request an opportunity to present additional evidence or testimony regarding the application. The Board hearing, which is scheduled for a date and time certain at 10:00 a.m., Tuesday, March 19, 2024, in the Board Hearing Room, Room 200, on the second floor of the Linn County Courthouse, is at least seven days from the initial Commission hearing and provides adequate opportunity to present additional evidence and testimony for the record.

If additional documents or evidence are provided by any party at the Board hearing, the Board may allow a continuance or leave the record open to allow the parties a reasonable opportunity to respond.

If additional documents or evidence are provided by any party, the Commission may allow a continuance or leave the record open to allow the parties a reasonable opportunity to respond. The 150-day time limitations described in ORS 215.427 apply to the proposed Zoning Map amendment.

Prior to the conclusion of the initial evidentiary hearing, any participant may request an opportunity to present additional evidence or testimony regarding the application. Because the Board will conduct a second evidentiary hearing 30 days after the Commission hearing, the Commission may grant the request or may conclude the hearing and forward the matter to the Board, thus satisfying the request for an opportunity to present additional evidence or testimony. If the matter is not forwarded to the Board, the Commission shall grant the request by either (a) continuing the public hearing or (b) leaving the record open for additional written evidence or testimony. If the Commission grants a continuance, the hearing shall be continued to a date, time and place certain at least seven days from the initial hearing.

VI. EXHIBITS

- A. Application and Supporting Documents
- B. Decision Criteria
- C. Habitat Map
- D. Agency Comments
- E. Legal Notice & Correspondence